

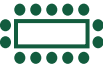

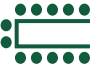

MEETING ROOM DIMENSIONS AND CAPACITY PLANS

| STYLE | | | BOARDROOM | HOLLOW SQUARE | U-SHAPE | CLASSROOM | BANQUET | THEATRE |
|--------------------|-----------|---------------------|---|---|--|---|---|---|
| Event room | Room Size | Room dimensions (m) |  |  |  |  |  |  |
| Rayong | 195 | 9.5 x 20.60 | - | - | 32 | 96 | 100 | 154 |
| Rayong 1 | 98 | 9.5 x 10.30 | - | - | 16 | 32 | 50 | 70 |
| Rayong 2 | 98 | 9.5 x 10.30 | - | - | 16 | 32 | 50 | 70 |
| Grand Ballroom | 478 | 13 x 36.75 | - | - | 66 | 220 | 320 | 360 |
| Grand Ballroom 1 | 151 | 13 x 11.6 | - | - | 22 | 50 | 60 | 108 |
| Grand Ballroom 2 | 153 | 13 x 11.8 | - | - | 22 | 50 | 60 | 108 |
| Grand Ballroom 3 | 174 | 13 x 13.35 | - | - | 22 | 50 | 60 | 108 |
| Grand Ballroom 1&2 | 304 | 13 x 23.40 | - | - | 46 | 110 | 150 | 270 |
| Grand Ballroom 2&3 | 327 | 13 x 25.15 | - | - | 46 | 110 | 150 | 150 |

FLOOR PLAN

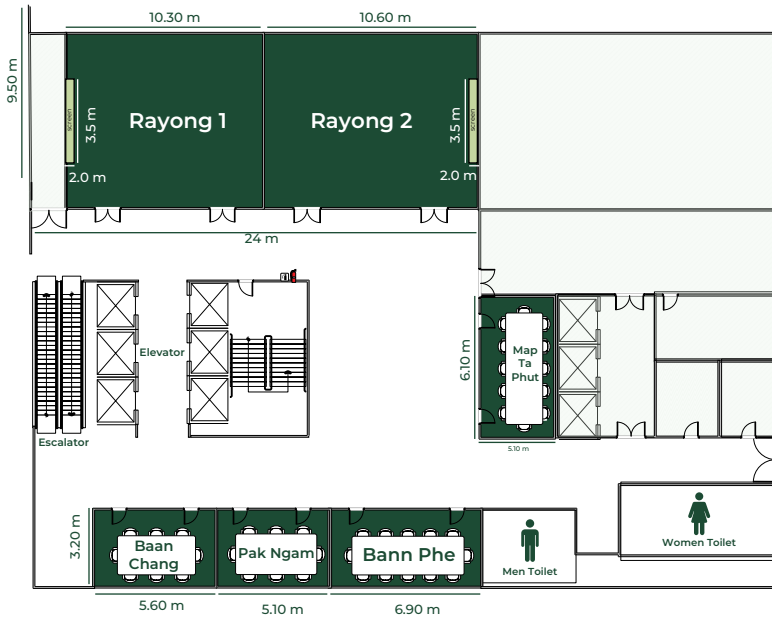

Floor 6

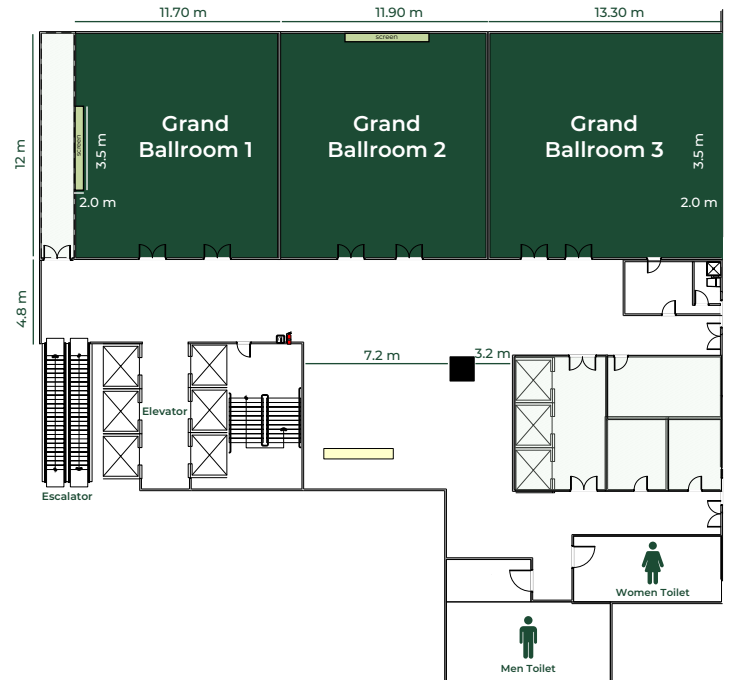

Floor 7